

## Table Overshelf Assembly Instructions

### 1. Check the parts needed for the assembly

Type A: Applicable to EPBNR1, EPBR1, EPBNSR2, EPBSR2, EPBNR2, EPBR2, EPBNWR2, EPBNR3, EPBR3, EPR1(-24), EPPR1, EPR2(-24), EPPSR2, EPWR2, EPPR2 and EPR3. Also applicable to the models with drawers.

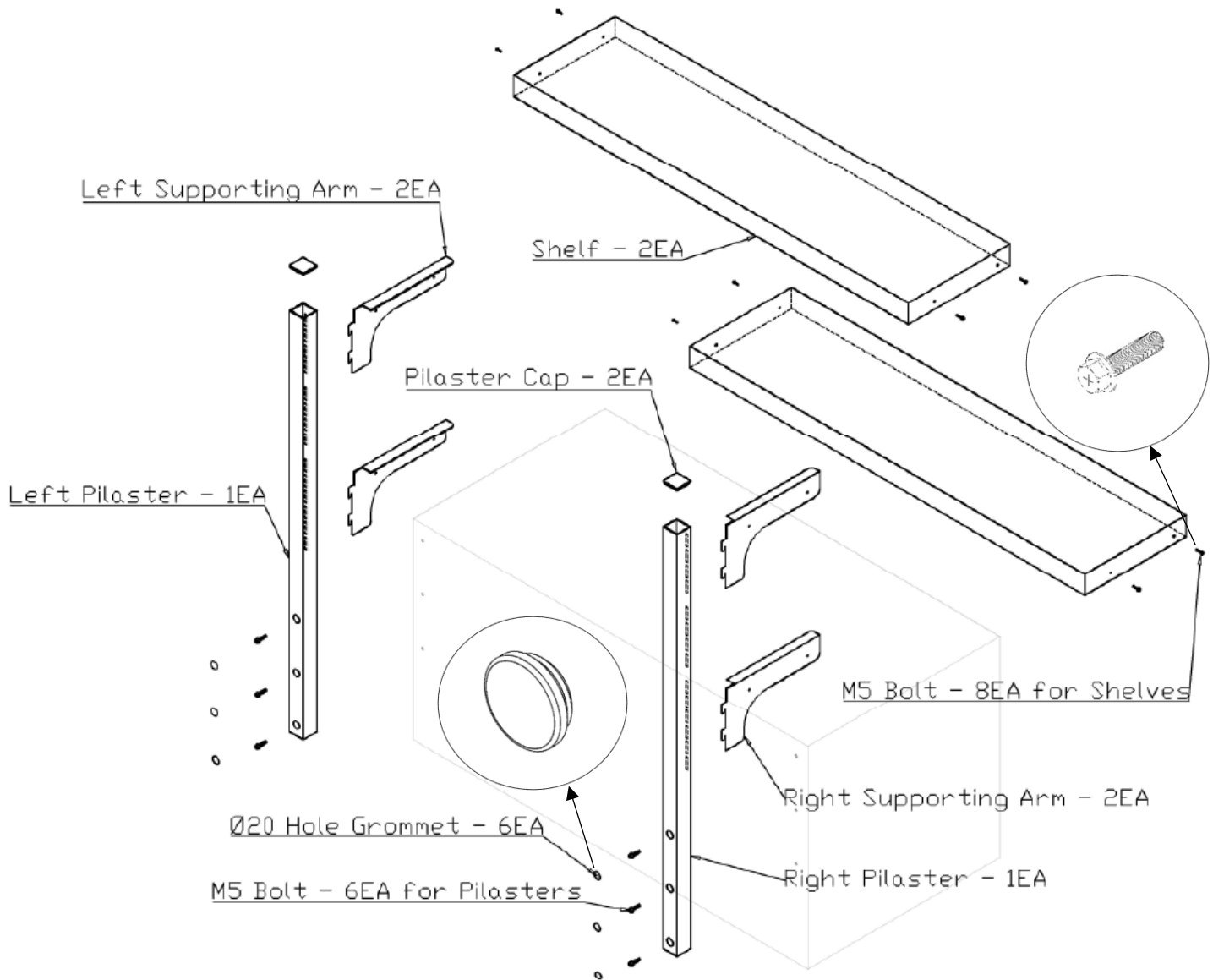

### Part Numbers:

S = Shelf

A1 = Left Supporting Arm, A2 = Right Supporting Arm

P1 = Left Pilaster, P2 = Right Pilaster

C = Pilaster Cap

G = 20ø Hole Grommet

B = M5 Bolt

Type B: Applicable to EPPR3, EPPR3-D2 and EPPR3-D4

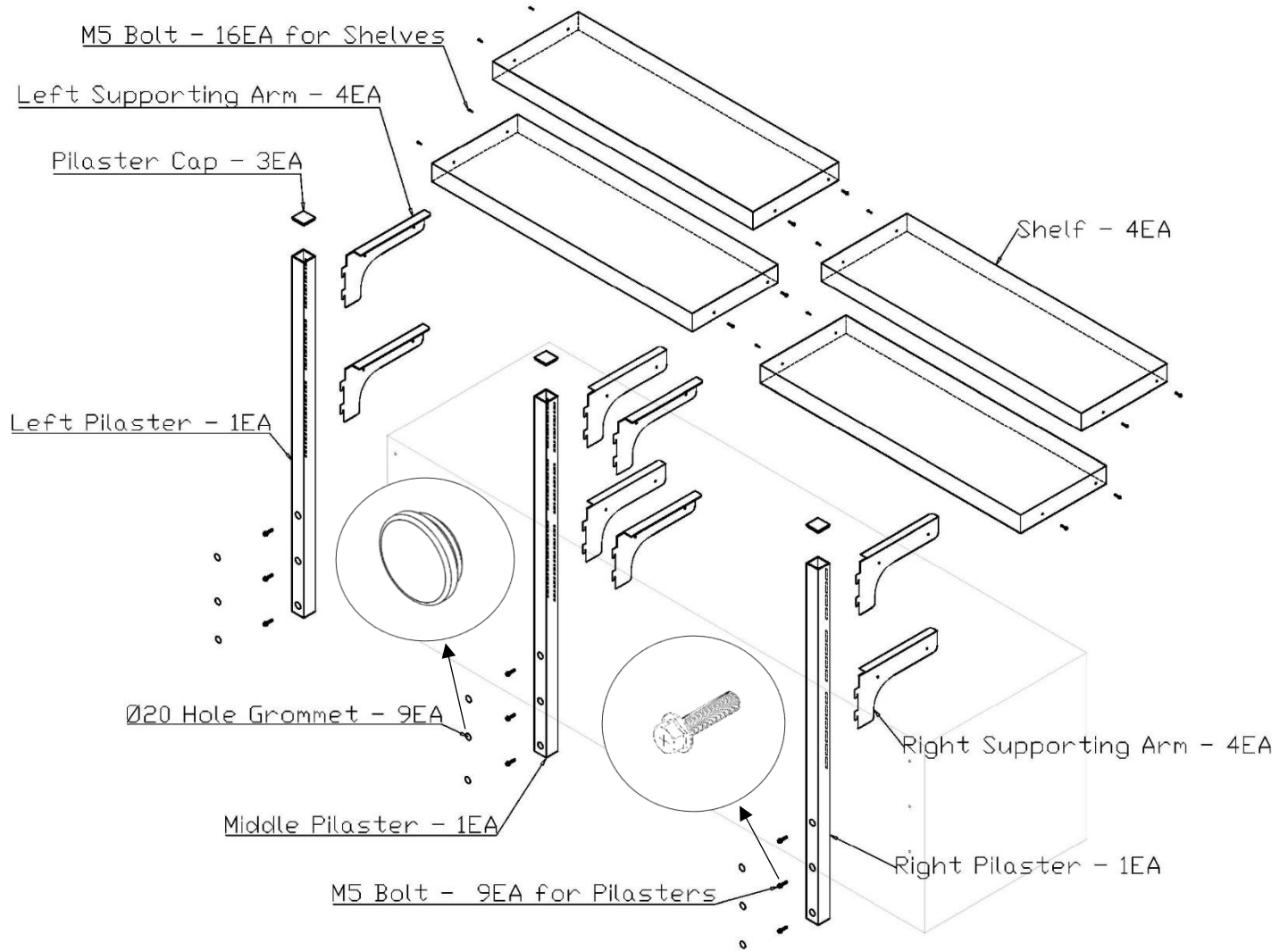

Part Numbers:

S = Shelf

A1 = Left Supporting Arm, A2 = Right Supporting Arm

P1 = Left Pilaster, P2 = Right Pilaster, P3 = Middle Pilaster

C = Pilaster Cap

G = 20Ø Hole Grommet

B = M5 Bolt

Additional Parts needed for assembly:

Electric Nut Driver (Do not use screw driver)

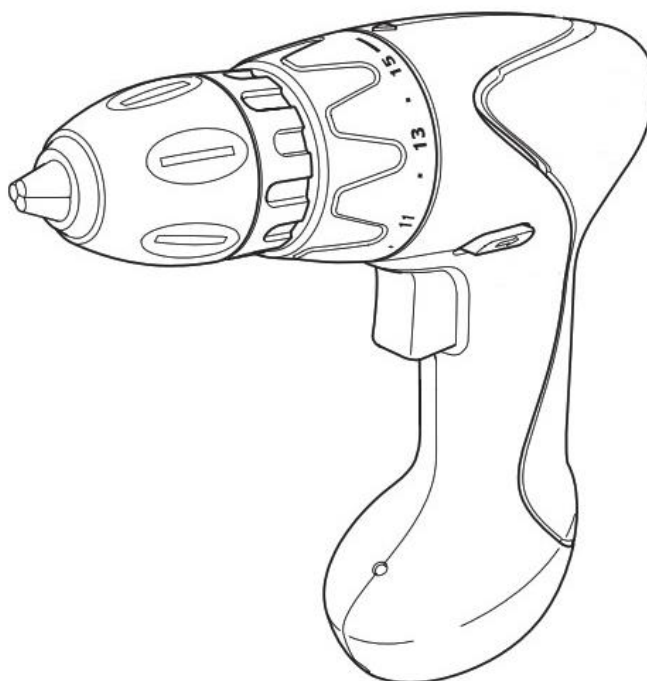

8 mm Hex Magnetic Nut Driver Bit

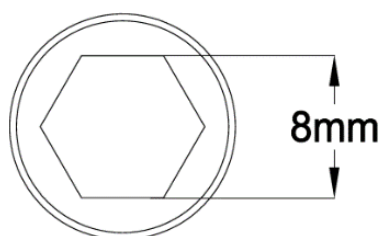
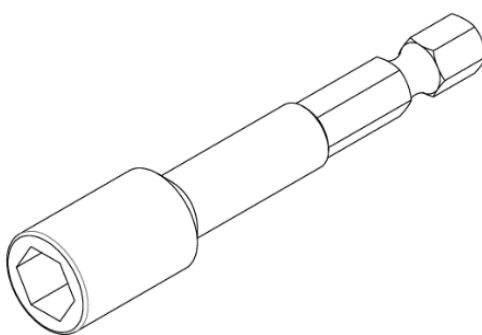

2. Follow the steps below to complete the Assembly. Overshelf will be installed on the rear side of the units.

### Type A

Step 1: Remove the M5 bolts (B) from the pre-made holes on the back of the unit. Use the electric nut driver and 8 mm hex magnetic nut driver bit for the M5 bolts (B).

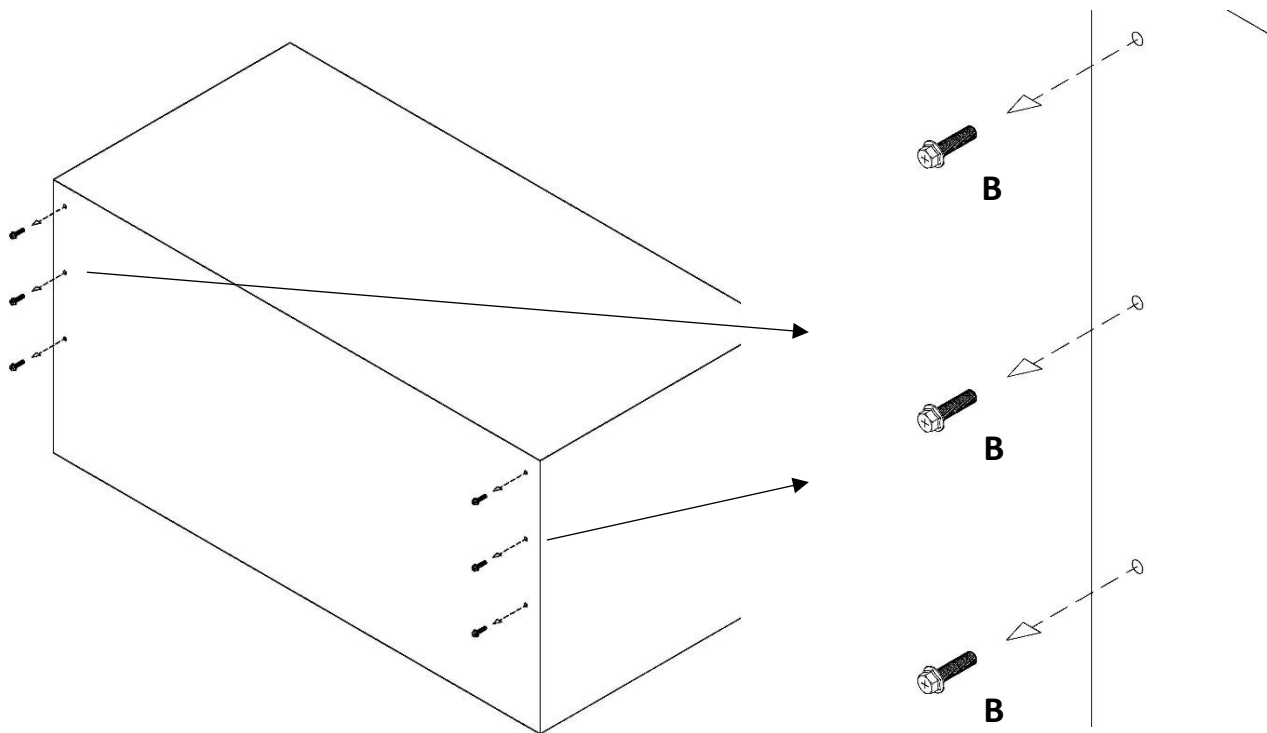

Step 2: Align the screw holes on the pilasters (P1 and P2) with the pre-made holes on the unit. Make sure to use the correct pilasters for each side. The arm slots should be placed on the outer edges of each pilaster.

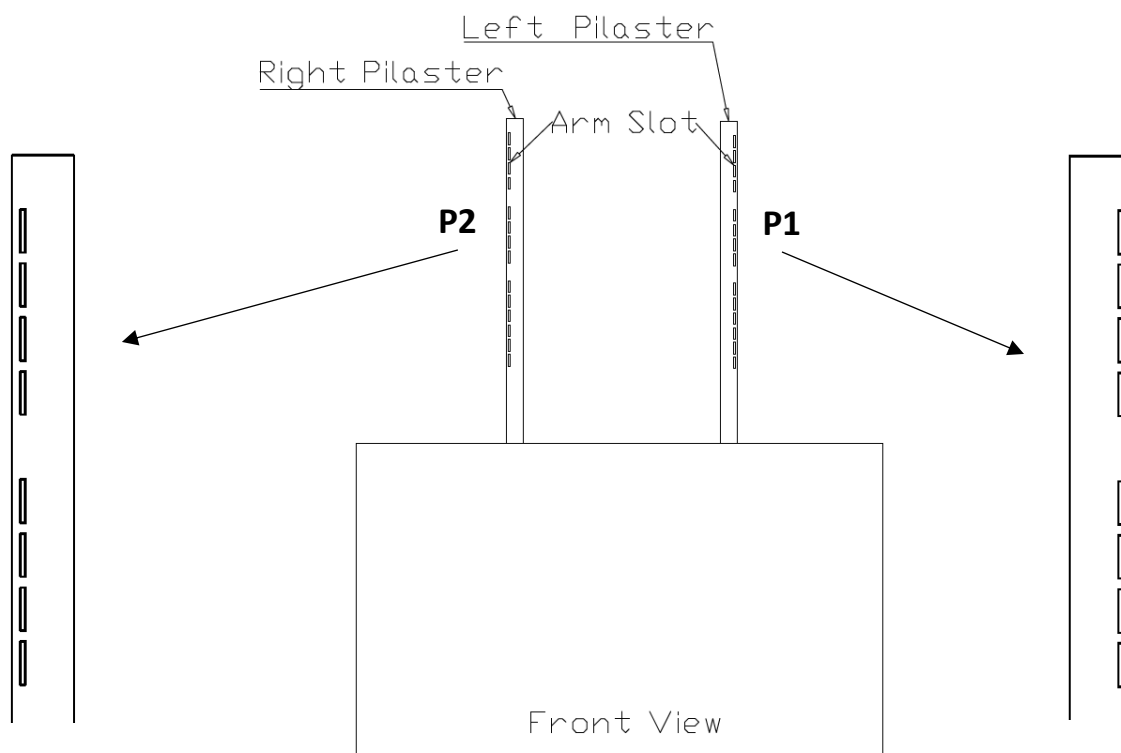

Step 2 Continued: Mount the pilasters (P1 and P2) on the unit with the M5 bolts (B) and cover the holes with the grommets (G). Use the electric nut driver and 8 mm hex magnetic nut driver bit for the M5 bolts (B).

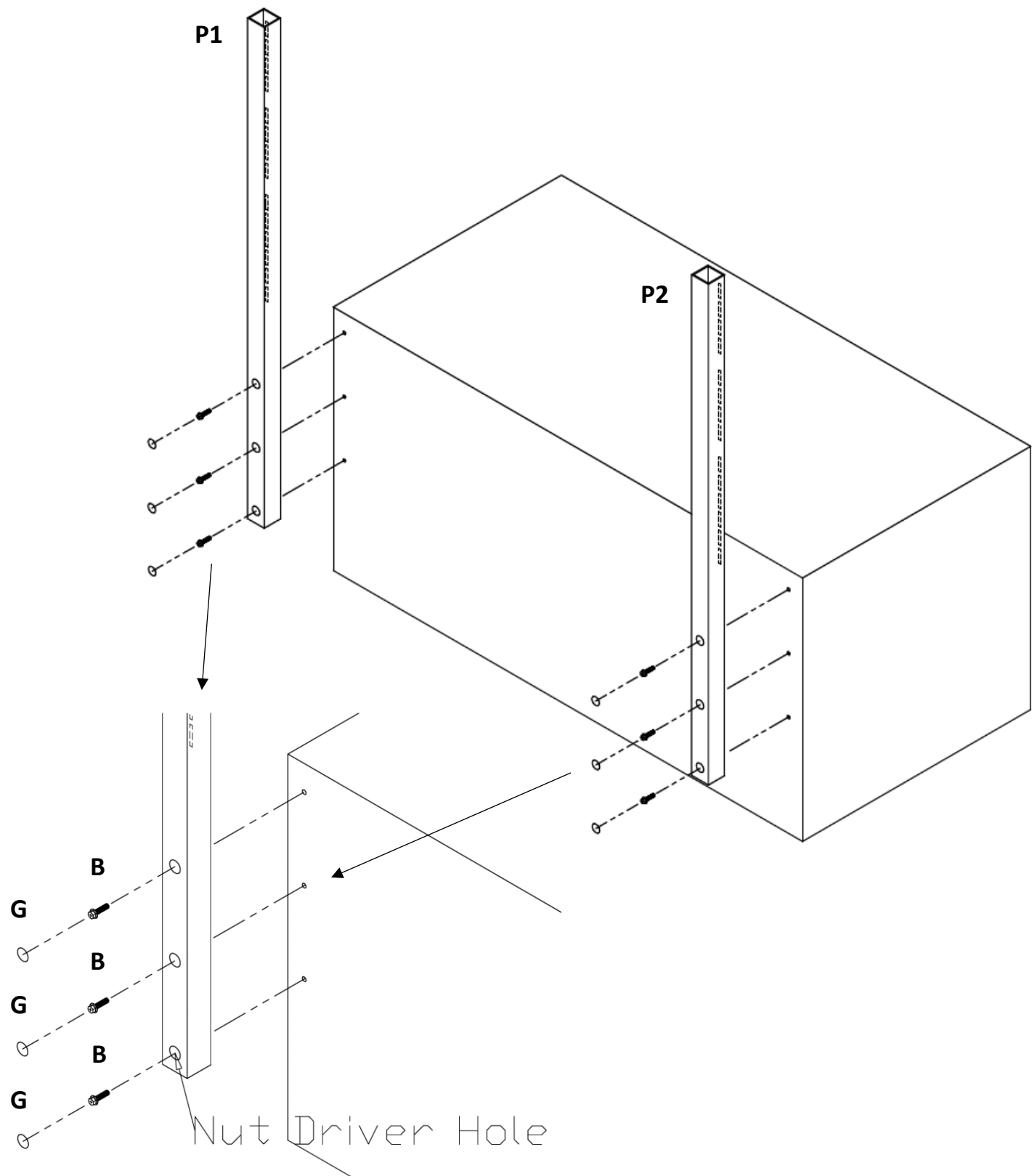

Step 3: Plug the pilaster caps (C) into the top holes of the pilasters (P1 and P2). Choose the preferred slots on the pilasters (P1 and P2) and insert the protruded hooks of the supporting arms (A1 and A2) into them. Make sure to use the correct arms for each side. The bending on the supporting arms should be facing inside.

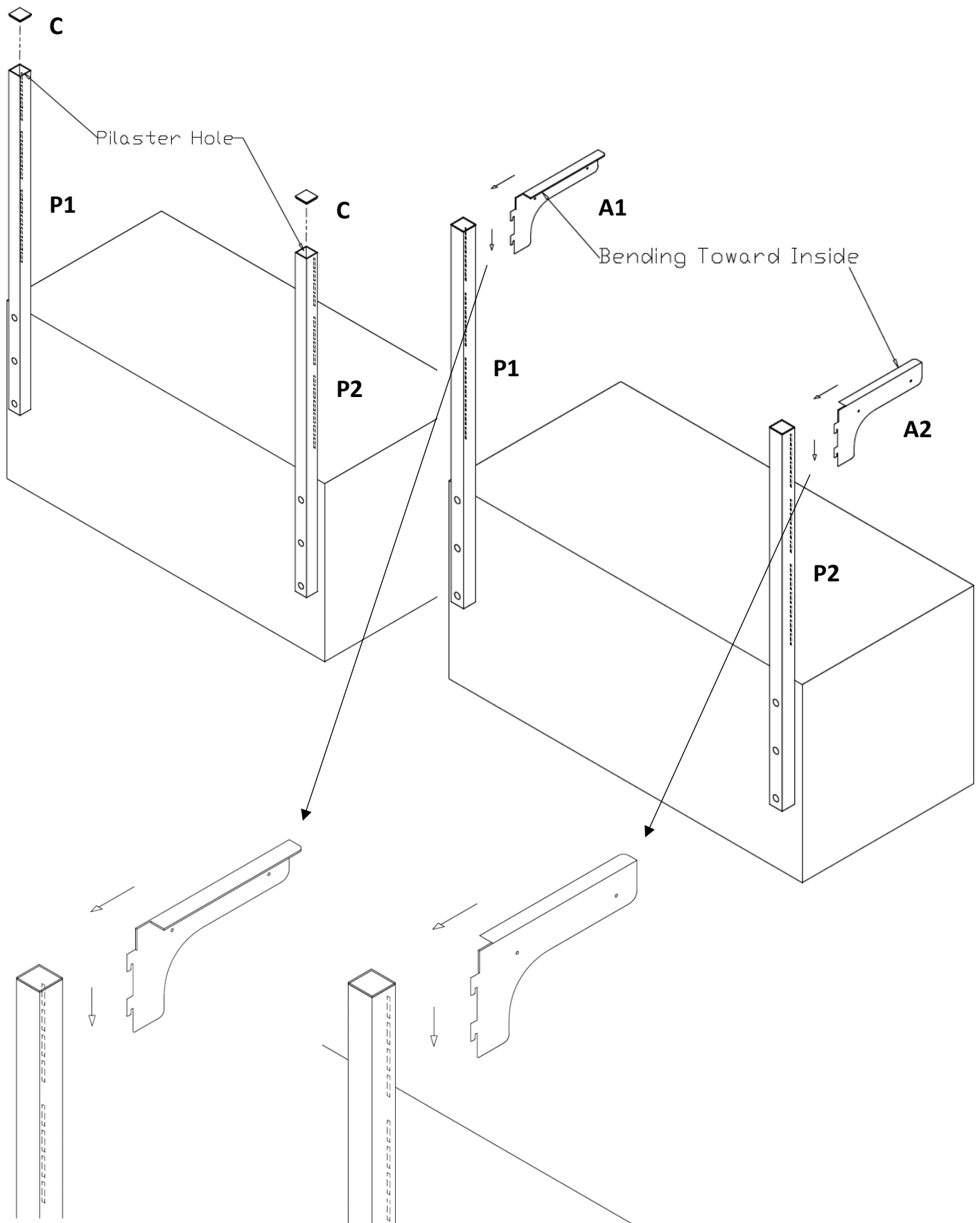

Step 4: Place the shelf (S) on the supporting arms (A1 and A2). Make sure the screw holes on the shelf and the arms are concentric with each other.

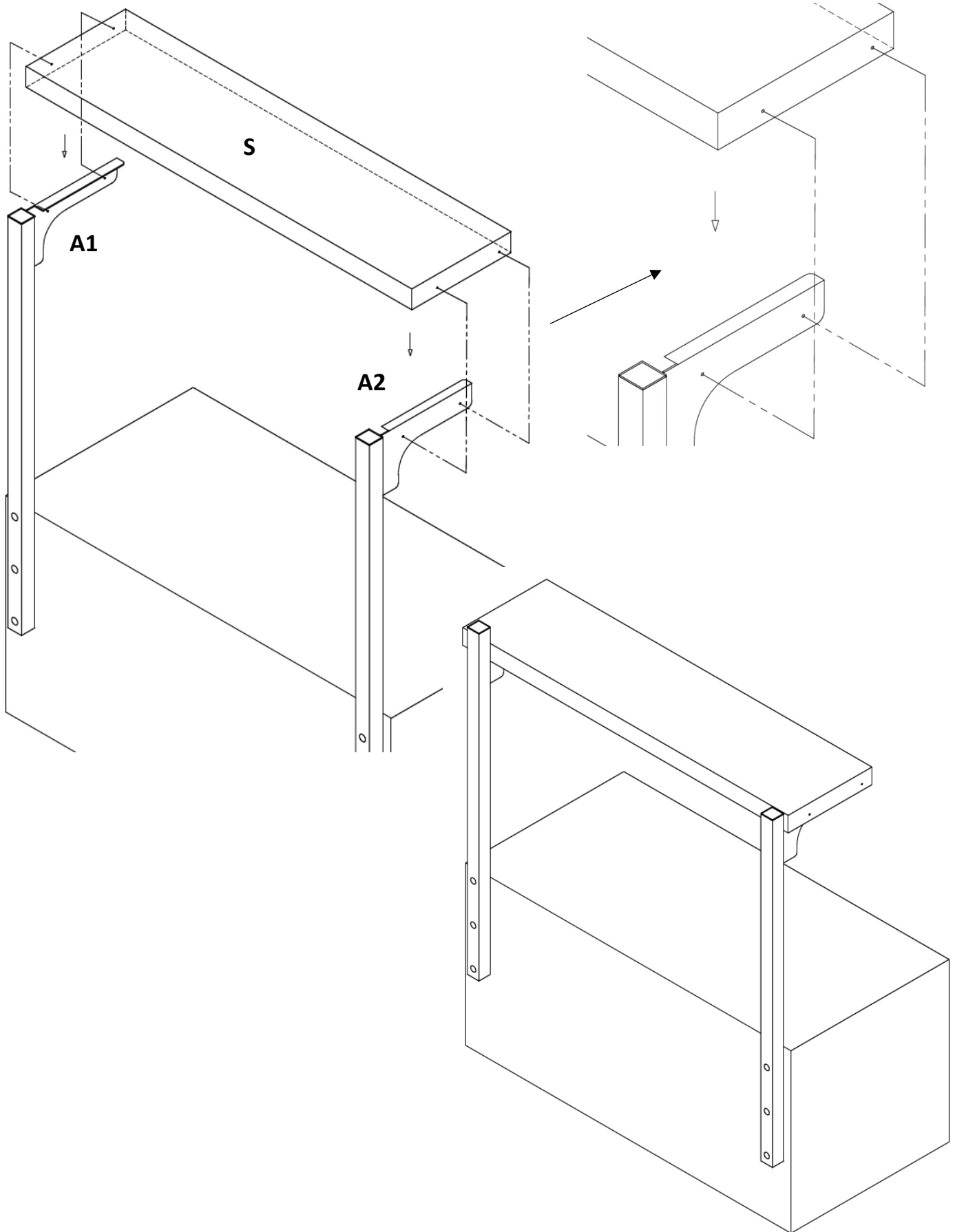

Step 5: Secure the shelf (S) on the supporting arms (A1 and A2) with M5 bolts (B). Use the electric nut driver and 8 mm hex magnetic nut driver bit for the M5 bolts (B).

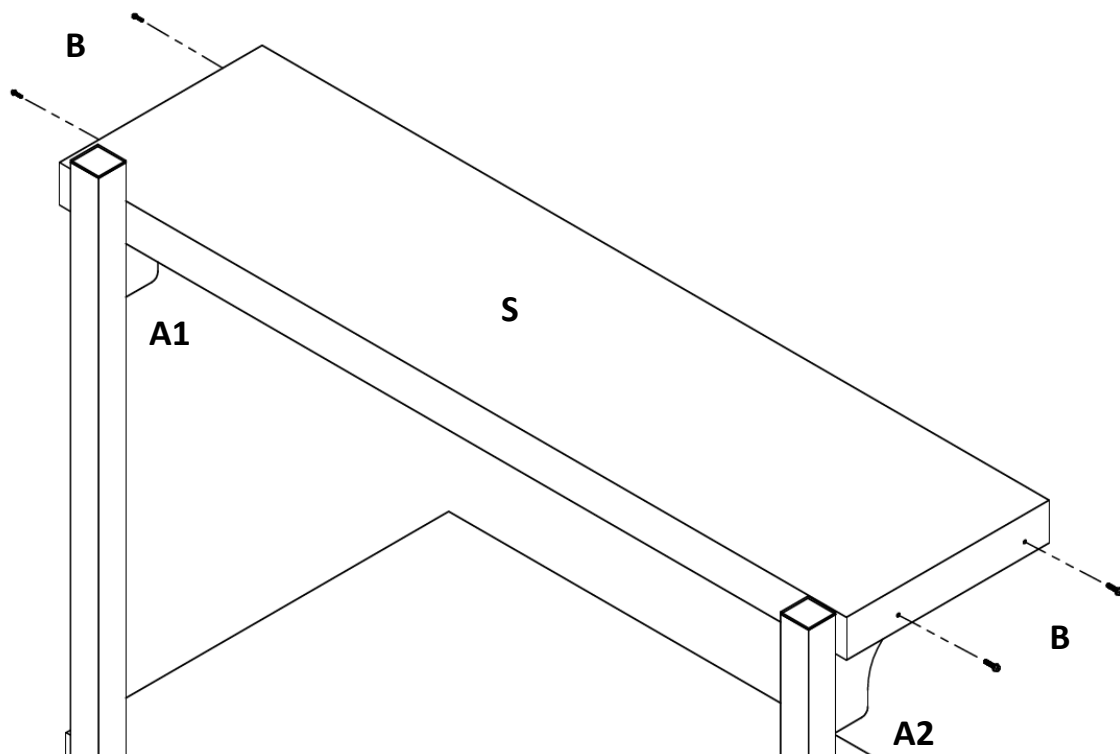

Step 6: Repeat steps 4 and 5 for the second shelf (S).

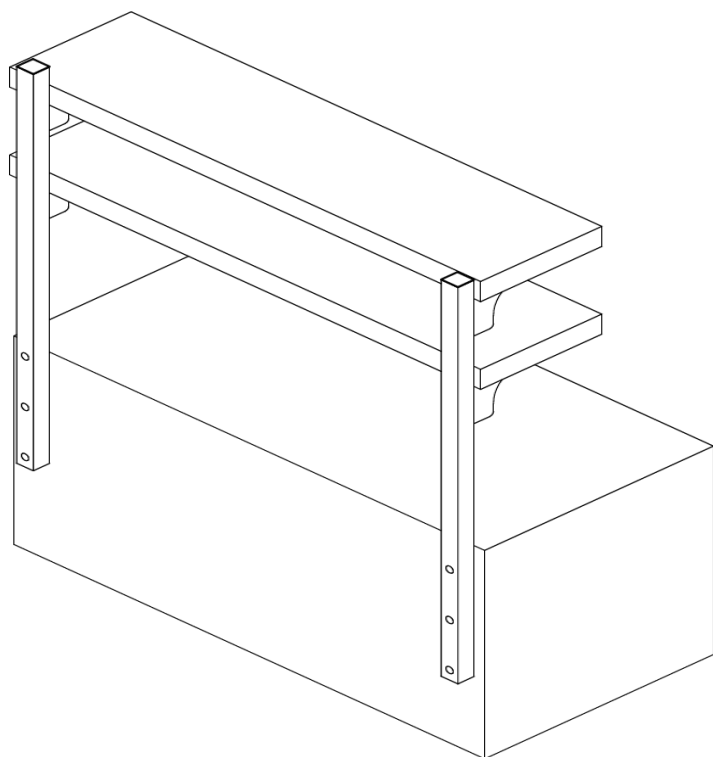

The assembly is complete. It is ready for use now.



## Type B

The assembly of Type B is almost identical to the one of Type A. The only difference is that Type B includes the middle pilaster (P3) due to the long width of the models. The middle pilaster (P3) has the arm slots for both left and right supporting arms (A1 and A2). Type B takes 4 shelves (S), 4 left supporting arms (A1) and 4 right supporting arms (A2) in total. The complete assembly of Type B is as shown below.

